

Decades of Caring for You – Right Here at Home



Our Mission: Cultivate community involvement and support the hospital's vision through advocacy, financial support, and stewardship.

Why? To support your community hospital as we collectively strive to always "serve our community with excellent patient-centered care."

Who? More than 1,500 donors and growing who work together to support 25 specialty areas, over 70 departments, 100 providers, and 800 employees who provide our community with medical excellence, right here at home.

2000

2000: Patient wing expansion completed with community philanthropy effort of \$3 million.

2004: Griffith Emergency Department opened thanks to community & partner support of \$2.5 million.

2007: Watt Dialysis Center opened thanks to the generous donation by The Joe & Arlene Watt Foundation & support from the Bob Bishop Dialysis Endowment.



2010

2013: Welch Cancer Center celebrates its grand opening, thanks to \$6 million in community support, allowing for cancer diagnosis and treatment – right here at home.

2016: Intensive Care Unit opens, expanding capacity from 6 to 11 private rooms, which became pivotal to our community's health during the pandemic.



2020

2022: Transitional Care Unit Opens, transforming the TCU capacity from 8 to 20 private patient rooms.

2023: Growing for You Campaign kickoff with a Phase I focus on a critical need for behavioral health & emergency care in our growing community.

2026: Behavioral Health Unit to open.



Growing for You

Behavioral Health & Emergency Medicine

Healthcare for our community continues to grow and diversify. To meet these critical needs, Sheridan Memorial Hospital is developing a Behavioral Health and Crisis Stabilization Unit to create a separate physical environment to better address the behavioral and mental health needs of patients in crisis.

Project includes:

- Psychiatric care and crisis stabilization for immediate behavioral and mental health needs
- Compassionate care from specially trained clinical staff
- Therapeutic setting and resources to initiate behavioral and mental health treatment
- Strengthen continuum of care within the community health system

Project Phases

- Pharmacy, Respiratory Therapy & Materials Management
Winter 2023 - Summer 2024
- Emergency Department
Summer 2024 - Fall 2024
- Pediatrics
Summer 2024 - Winter 2025
- Medical-Surgical
Fall 2024 - Winter 2026
- Behavioral Health
Fall 2024 - Winter 2026

Total Project Estimate: \$15 Million

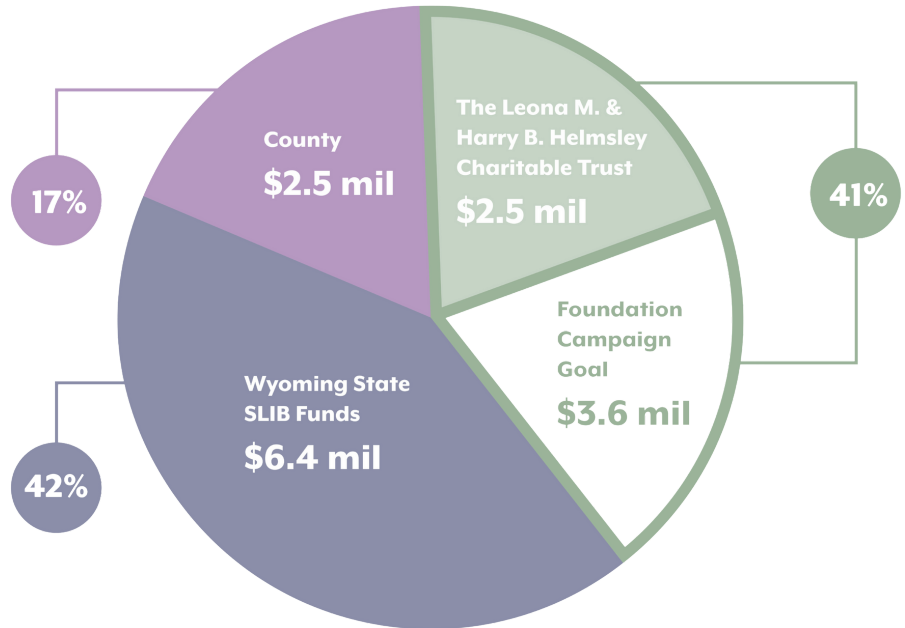

Foundation Campaign Goal: \$6.1 Million

Amount Left to raise as of April 2024: \$1.2 Million

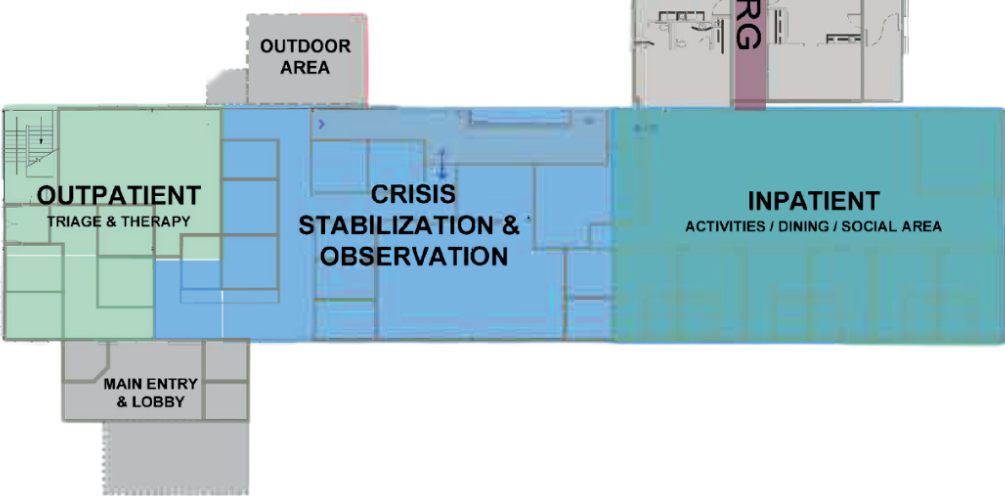
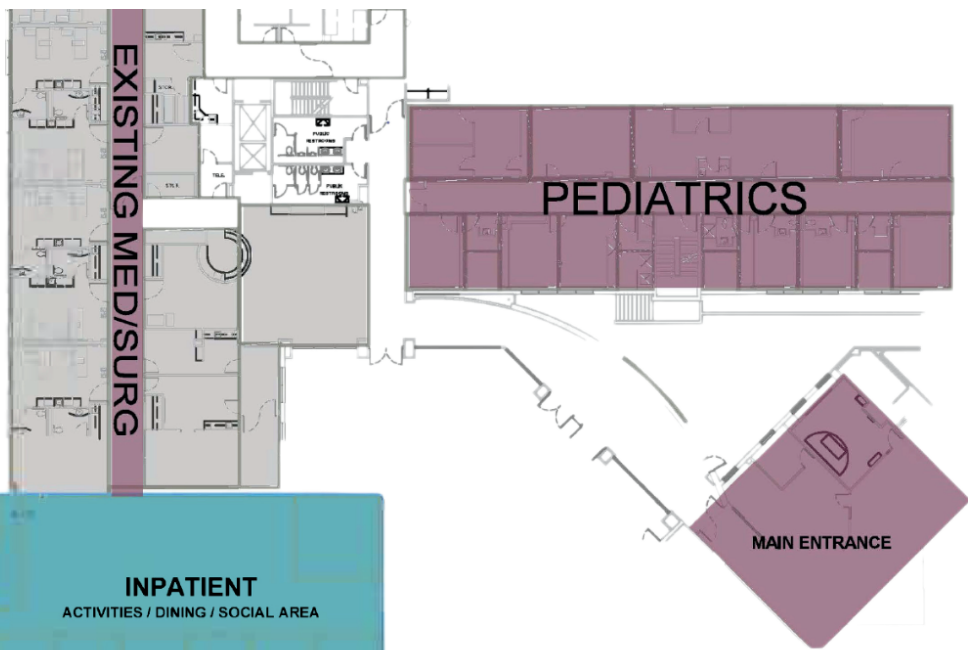



Sheridan Memorial Hospital Behavioral Health Project Project Overview, March 2024

Project Vision

“Where do I go?” Members of Wyoming communities ask this question in desperation when in need of mental health care for themselves, friends and family. A system of care riddled with gaps leaves Wyomingites suffering and vulnerable to crisis, conditions compounded by the limited access to specialized mental health care in an outpatient setting. As a state, Wyoming ranks 49th in psychiatrists per capita with only 51 psychiatrists serving the entire state. As a result, compared to the rest of the nation, Wyoming has one of the highest rates of adults with mild or moderate mental illness who did not receive treatment in the last year and adults and teens reporting alcohol abuse or dependence. Often leading the country in suicide rates over the last decade, however, is the most devastating outcome to the lack of access to mental health care in the Cowboy State.

Members of Sheridan County in need of mental health care share a similar experience to the rest of Wyoming. Sheridan County has mental health providers including counselors and psychologists but outpatient psychiatric services are currently unavailable to patients outside the VA system. Patients then must rely on primary care providers, travel at least two hours or locate a tele-health service to see a psychiatric provider. These barriers lead to fragmented care, where mental health needs are not adequately addressed, negatively impacting patients’ overall health and wellness and increasing the potential for experiencing a mental health crisis.

Goals & Objectives

In line with its commitment to excellent patient-centered care close to home, SMH will build a system of care in Sheridan County to ensure those struggling with mental health have “a place to go.” Expected to begin caring for patients early 2027, the SMH Behavioral Health Unit will offer outpatient psychiatric care, acute crisis stabilization and inpatient psychiatric treatment to ensure members of our community can receive excellent healthcare in Sheridan.

Strategy

The Behavioral Health Unit will provide the infrastructure and specialized psychiatric care needed in our community. The space will include areas for outpatient treatment, crisis stabilization and inpatient care, providing services for individuals no matter where they are in their health care journey.

Outcomes

- Recruit and hire specialized psychiatric care staff
- Reduce the number of patients who have to leave the community for care
- Increase the number of patients seeking mental health care voluntarily
- Expand and connect behavioral health services throughout our community
- Reduce the stigma around mental health care by increasing community education
- Provide the appropriate level of care for mental health crises outside the Emergency Department